



MOTO-LITA have been designing and making custom steering wheels since the 1950s. AC Cars, Aston Martin, Cooper Car Co., Caterham, Jensen, Lister, Lola, MG, Opel, Panther, Rolls-Royce, Rover, Saab, Shelby Mustang, Triumph, TVR and Vauxhall are some of the companies who have chosen MOTO-LITA steering wheels for their quality, enhanced driving comfort and good looks. MOTO-LITA steering wheels are designed and hand built in England by British craftsmen.

The centres of Moto-Lita's steering wheels are hewn from a solid billet of aluminium. With this in mind we're afraid that you might have to wait a while if you order a 16" wheel and it's not in stock. The solid cylinder of aluminium is very heavy and they don't like picking it up and putting onto their cutting saw to make only one wheel! 16" wheels are made to order only

Unless stated, for all of these steering wheels you will need a boss to fit it to your car. Please see following pages for details

The original classic British Wood Rim Steering Wheel. Built from selected cross-laminated wood which is bonded and rivetted to a one piece, heavy gauge, hand polished, aluminium alloy frame. The underside of the rim has 36 carved finger notches. The rim is finished in a hardwearing deep lustre which is resistant to petrol, oil and the elements

- LIGHTING
- SWITCHES
- IGNITION
- WIRING
- HEATERS, ELECTRIC FANS
- FUEL AIR
- GAUGES
- WASHERS WIPERS
- MIRRORS
- SEATS, SEAT BELTS

STEERING WHEELS

- MOTORCYCLE PARTS
- ACCESSORIES
- BODY HARDWARE
- CAR CARE PAINT
- OIL, GREASE
- FITTINGS
- WHEELS, BRAKES
- TOOLS
- COMPETITION
- CLOTHING
- GIFTS
- BOOKS



MARK THREE DRILLED SPOKES

Flat wheels:

Dia (mm)	Part No.	Price each	ex VAT
330(13")	090.053	£170.40	£142.00
356(14")	090.054	£170.40	£142.00
381(15")	090.055P	£170.40	£142.00
406(16")	090.056	£284.52	£237.10

Dished wheels:

Dia (mm)	Part No.	Price each	ex VAT
330(13")	090.057	£170.40	£142.00
356(14")	090.058	£170.40	£142.00
381(15")	090.059	£170.40	£142.00
406(16")	090.060	£273.60	£228.00



MARK THREE WITH SLOTS

Flat wheels:

Dia (mm)	Part No.	Price each	ex VAT
330(13")	090.063	£170.40	£142.00
356(14")	090.064	£170.40	£142.00
381(15")	090.065	£170.40	£142.00

Dished wheels:

Dia (mm)	Part No.	Price each	ex VAT
330(13")	090.066	£170.40	£142.00
356(14")	090.067	£170.40	£142.00
381(15")	090.068	£170.40	£142.00



MARK THREE TEARDROP SLOTS

Flat wheels:

Dia (mm)	Part No.	Price each	ex VAT
356(14")	090.670	£170.40	£142.00
381(15")	090.671	£170.40	£142.00

Dished wheels:

Dia (mm)	Part No.	Price each	ex VAT
356(14")	090.672	£170.40	£142.00
381(15")	090.673	£170.40	£142.00

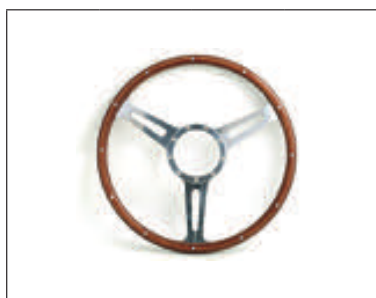

DERRINGTON SLOT

With slots in the spokes. Flat wheels:

Dia (mm)	Part No.	Price each	ex VAT
381 (15")	090.628	£207.60	£173.00
406 (16")	090.629	£279.60	£233.00

VW Derrington was an aftermarket company supplying bolt-on-goodies in the classic era. Moto-Lita made Steering Wheels for them in period. Their particular feature is equally spaced spokes



DERRINGTON - JAGUAR

As originally supplied by Moto-Lita to VW Derrington for the *Jaguar Mk II*. Three plain spokes. The underside of the rim has 36 finger notches. It comes complete with aluminium alloy boss and you refit the original horn ring. Made to special order, allow time for delivery

Dia (mm)	Part No.	Price each	ex VAT
406(16 in)	090.629JAG	£393.60	£365.00



CLASSIC FOUR SPOKE

Classic four spoke. Like the Bentley Boys wheels! Laminated wood and rivetted rim

Flat wheels only:

Dia (mm)	Part No.	Price each	ex VAT
356(14")	090.050	£220.99	£184.16
381(15")	090.051	£220.99	£184.16
406(16")	090.052	£297.76	£248.13

WOOD RIM STEERING WHEELS

+44(0) 1885 488 488

- LIGHTING
- SWITCHES
- IGNITION
- WIRING
- HEATERS, ELECTRIC FANS
- FUEL AIR
- GAUGES
- WASHERS WIPERS
- MIRRORS
- SEATS, SEAT BELTS
- STEERING WHEELS**
- MOTORCYCLE PARTS
- ACCESSORIES
- BODY HARDWARE
- CAR CARE PAINT
- OIL, GREASE
- FITTINGS
- WHEELS, BRAKES
- TOOLS
- COMPETITION
- CLOTHING
- GIFTS
- BOOKS



ASTON MARTIN REPLICA

A true replica of the **Aston Martin DB2/3/4/5/6** steering wheel. Flat wheel only. Fits the Moto-Lita bosses below or the original boss on the car. 406mm (16") diameter. Holes not c/sunk.

Finish	Part No.	Price each	ex VAT
Black	090.953	£358.80	£299.00
Polished	090.957	£358.80	£299.00



BOSSSES FOR ASTON MARTINS

Boss for above Steering Wheels for **Aston Martin DB2/3/4**. Horn Control is provided with this boss (shown)

Part No.	Price each	ex VAT
098.B7H	£91.20	£76.00

Boss for above Steering Wheels for **Aston Martin DB5 and DB6**. Horn Control is provided with this boss

Part No.	Price each	ex VAT
098.B49A/9H	£78.00	£65.00



JAGUAR 'D' TYPE REPLICA

A true replica of the Le Mans winning **Jaguar 'D' Type** steering wheel. Flat wheel only. Fits original boss in the car, not Moto-Lita bosses

Dia (mm)	Part No.	Price each	ex VAT
381 (15")	090.088	£318.00	£265.00



AC COBRA REPLICA

A true replica of the original **AC Cobra** split centre steering wheel. Fits the Moto-Lita boss below or the original Cobra boss. Includes top plate and screws

Dia (mm)	Part No.	Price each	ex VAT
381 (15")	090.954	£316.80	£264.00



BOSS FOR AC COBRA

Boss for above Steering Wheel for **AC Cobra**. There is no provision for a Horn Control in the centre

Part No.	Price each	ex VAT
098.B25	£63.60	£53.00



MGA REPLICA & BOSS

For the **MGA** we offer this wood rim steering wheel, which is supplied complete with the boss to fit to the cars standard column and with the MG badge in the centre

Dia (mm)	Part No.	Price each	ex VAT
432 (17")	090.090	£510.00	£425.00



JAGUAR 'E' TYPE REPLICA

True replicas of the works **Jaguar 'E' Type** wheel as fitted as original equipment for Series 1 & 1 1/2 cars. Fits the Moto-Lita boss below or the original boss on the car. Flat wheels only

Dia (mm)	Part No.	Price each	ex VAT
381(15")	090.061	£297.76	£248.13
406(16")	090.062	£288.00	£240.00



BOSS & HORN PUSH FOR JAGUAR E TYPE

Boss for above Steering Wheels. Made from billet aluminium and highly polished, fits original **E Type** column. Takes OE (Original Equipment) horn control or you can use the special **Jaguar** horn control below

Part No.	Price each	ex VAT
090.596	£126.00	£105.00

Horn Push, together with Boss 090.596 this is for use with Steering Wheels 090.061 and 090.062 above

Part No.	Price each	ex VAT
090.500	£74.36	£61.97



MOTO-LITA SPACER

Fits between the boss and the steering wheel to bring the latter closer to you. Black crackle finish. Supplied with nine longer screws to secure the steering wheel through the spacer into the boss. Originally made for the **Jaguar XK120**

12.5mm (1/2")	090.858
19mm (3/4")	090.608
25mm (1")	090.859
Price	£44.40 each £37.00 ex VAT

LEATHER RIM STEERING WHEELS

The classic British leather rim steering wheel, suitable for virtually all cars from a 1950s sports car to the latest saloon. Made from top quality black leather, handsewn over a natural rubber handgrip, with each spoke having an integral soft padded thumb grip. The traditionally drilled heavy gauge aluminium alloy spokes are either anodised matt black or polished. Unless stated, for all of these steering wheels you will need a boss to fit it to your car. Please see following pages for details

Moto-Lita

			
MARK FOUR POLISHED SPOKES			
With polished spokes. Flat wheels:			
<i>Dia (mm)</i>	<i>Part No.</i>	<i>Price each</i>	<i>ex VAT</i>
279 (11")	090.079*	£170.40	£142.00
305 (12")	090.091*	£170.40	£142.00
330 (13")	090.082	£170.40	£142.00
356 (14")	090.083	£170.40	£142.00
381 (15")	090.084	£170.40	£142.00
Dished wheels:			
<i>Dia (mm)</i>	<i>Part No.</i>	<i>Price each</i>	<i>ex VAT</i>
330 (13")	090.947	£170.40	£142.00
356 (14")	090.077	£170.40	£142.00
381 (15")	090.085	£170.40	£142.00
*No holes in the spokes			

			
MARK FOUR BLACK SPOKES			
With matt black spokes. Flat wheels:			
<i>Dia (mm)</i>	<i>Part No.</i>	<i>Price each</i>	<i>ex VAT</i>
330 (13")	090.073	£170.40	£142.00
356 (14")	090.074	£170.40	£142.00
381 (15")	090.075	£170.40	£142.00
Dished wheels:			
<i>Dia (mm)</i>	<i>Part No.</i>	<i>Price each</i>	<i>ex VAT</i>
330 (13")	090.076	£170.40	£142.00
356 (14")	090.081	£170.40	£142.00
381 (15")	090.078	£170.40	£142.00

			
MARK FOUR WITH SLOTS			
With slots in the spokes. Flat wheels:			
<i>Dia (mm)</i>	<i>Part No.</i>	<i>Price each</i>	<i>ex VAT</i>
330 (13")	090.625	£170.40	£142.00
356 (14")	090.626	£170.40	£142.00
381 (15")	090.627	£170.40	£142.00

			
MARK 4 (SOLID SPOKES) DISHED SVA REGULATED LEATHER STEERING WHEEL			
Plain polished spokes. Designed to meet the SVA Regulations for kit cars			
<i>Dia (mm)</i>	<i>Part No.</i>	<i>Price each</i>	<i>ex VAT</i>
356 (14")	090.099	£170.40	£142.00

SET OF SCREWS

(Right) Set of screws for Motolita Steering Wheels with polished heads

098.001

£7.20 each | £6.00 ex VAT



- LIGHTING
- SWITCHES
- IGNITION
- WIRING
- HEATERS, ELECTRIC FANS
- FUEL AIR
- GAUGES
- WASHERS WIPERS
- MIRRORS
- SEATS, SEAT BELTS

STEERING WHEELS

- MOTORCYCLE PARTS
- ACCESSORIES
- BODY HARDWARE
- CAR CARE PAINT
- OIL, GREASE
- FITTINGS
- WHEELS, BRAKES
- TOOLS
- COMPETITION CLOTHING
- GIFTS
- BOOKS

BOSSES FOR STEERING WHEELS

+44(0) 1885 488 488

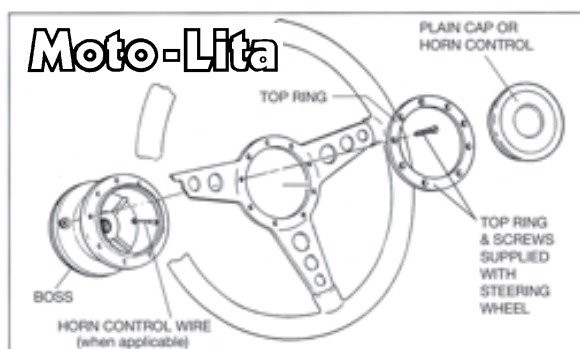

Mota-Lita bosses are machined from aluminium alloy castings and are stove enamelled wrinkle black. Each boss is splined to fit a particular steering column, and enables you to fit the Moto-Lita steering wheel of your choice. It is important to have the correct boss for your car. Please select a boss from the list below. If your car is not included here please phone our order line with details of your car: make, model and year

Bosses come fitted with either a plain cap or with a horn push which are moulded from black plastic and have a finish to match the boss. They have a indent to take a decal. They are supplied with an appropriate decal

Make	Model	Type of Wheel	Boss Part No.	Price each	Ex Vat
AC	Ace/Aceca. Accepts OE horn control	F	098.B7	£91.20	£76.00
AC	Cobra to fit Moto-Lita Steering Wheels	D	098.B25	£63.60	£53.00
AC	Greyhound		Special Order		
Aston Martin	DB2/DB3/DB4	F	098.B7H	£91.20	£76.00
Aston Martin	DB4/DB5/DB6 OEM Pinch Bolt Type	F	098.AST	£156.00	£130.00
Aston Martin	DB5/DB6	F/D	098.B49A/9H	£78.00	£65.00
Aston Martin	DBS to fit Moto-Lita Wood Rim Steering Wheels	D	098.B49A/9H	£78.00	£65.00
Aston Martin	DBS to fit Moto-Lita Leather Rim Steering Wheels		Special Order		
Aston Martin	V8, also Lagonda	D	098.F23EH	£134.40	£112.00
Aston Martin	Virage		Special Order		
Austin	A30, A35 abd A40 with original steering box		098.B5	£91.20	£76.00
Austin Healey	100/4, 100/6, 3000 with adjustable column. Accepts OE horn control	F	098.B7	£91.20	£76.00
Austin Healey	100/4, 100/6, 3000 with non-adjustable column. Accepts OE horn control	F	098.B6	£78.00	£65.00
Austin Healey	Sprite Mk 1/2	F	098.B4H	£63.60	£53.00
Austin Healey	Sprite Mk 3	F	098.B25H	£63.60	£53.00
Austin Healey	Sprite Mk 4	F	098.B25CH	£63.60	£53.00
Bentley	Continental, Eight, Mulsanne and Turbo R	D	098.B70H	£134.40	£112.00
Bentley	Other Models, specify spline diameter 5/8" or 3/4"		Special Order		
Caterham	Ford 1600GT/1600 GT Sprint/1700 Sprint/RS 1600 BDR	F	098.B20H	£63.60	£53.00
Daimler	250, Sovereign and Double Six to 1973	F	098.B33H	£63.60	£53.00
Daimler	Double Six and Sovereign 1974 on	F	098.B54H	£63.60	£53.00
Daimler	Double Six and Sovereign 2.9, 3.6 1987	F	098.B54AH	£91.20	£76.00
Daimler	SP250 with adjustable column. Accepts OE horn control	F	098.B7	£91.20	£76.00
Daimler	SP250 with non adjustable column	F	098.B1H	£63.60	£53.00
Daimler	SP250 with non-adjustable column. Accepts OE horn control	F	098.B220E	£91.20	£76.00
Ford	Anglia 105E	D	098.B14	£78.00	£65.00
Ford	E93A Side Valve	F/D	098.B36	£91.20	£76.00
Ford	Zephyr Mk 2, Zodiac Mk 2	D	098.B16H	£78.00	£65.00
Ford	Capri Mk 1 to 1972	D	098.B40	£78.00	£65.00
Ford	Capri Mk 2 to 1977	D	098.B48	£134.40	£112.00
Ford	Capri 1978 on	D	098.B48A	£134.40	£112.00
Ford	1600E, Cortina 1966-68, 1970, Lotus Cortina 1965 on	D	098.B18	£78.00	£65.00
Ford	Cortina 1965	D	098.B17	£78.00	£65.00
Ford	Cortina 1966-1968	D	098.B18	£78.00	£65.00

BOSSES FOR STEERING WHEELS

Make	Model	Type of Wheel	Boss Part No.	Price each	Ex Vat
Ford	Cortina 1969 only	D	098.B40	£78.00	£65.00
Ford	Cortina 1970 only	D	098.B18	£78.00	£65.00
Ford	Cortina Mk 3 1971-1973	D	098.B18A	£78.00	£65.00
Ford	Cortina Mk 3 1974 on, Escort Mk 2 and RS2000	D	098.B55	£91.20	£76.00
Ford	1600E	D	098.B18	£78.00	£65.00
Ford	Escort Mk 1 1968	D	098.B37	£78.00	£65.00
Ford	Escort Mk 1 1969-75	D	098.B37A	£78.00	£65.00
Ford	Escort Mk 2	D	098.B55	£91.20	£76.00
Ford	Escort Mk 3 to February 1986	D	098.B61	£78.00	£65.00
Ford	Escort March 1986 on	F/D	098.B61BH	£78.00	£65.00
Ford	RS2000	D	098.B55	£91.20	£76.00
Ford	Granada to 1982-1985	F	098.B61H	£78.00	£65.00
Ford	Granada May 1989 on, no cruise control	D	098.B61BH	£78.00	£65.00
Ford	Orion March 1986 on	D	098.B61H	£78.00	£65.00
Ford	Sierra to February 1987, horn in steering wheel	D	098.B61H	£78.00	£65.00
Ford	Sierra to February 1987, horn on stalk	D	098.B61	£78.00	£65.00
Ford	Sierra March 1987 on, horn in steering wheel	D	098.B61BH	£78.00	£65.00
Ford	Sierra March 1987 on, horn on stalk	D	098.B61B	£78.00	£65.00
Ford	XR4i	D	098.B61BH	£78.00	£65.00
Hillman	Imp	D	098.B27	£78.00	£65.00
Jaguar	XK120	F	098.B7H	£91.20	£76.00
Jaguar	XK120 to accept original horn control etc.	F	098.B7XK1200E	£134.40	£112.00
Jaguar	XK140/XK150/ Mk 1 Saloon	F	098.B32H	£63.60	£53.00
Jaguar	XK140/XK150/ Mk 1 Saloon (OE Horn Control)	F	098.B320E	£78.00	£65.00
Jaguar	Mk 8 and Mk 9	F	098.B320E	£78.00	£65.00
Jaguar	C Type	Special Order			
Jaguar	E Type	F	098.B33H	£63.60	£53.00
Jaguar	Mk 2 Saloon/Mk 10 Saloon/420/XJ6/XJ12 to '73	F	098.B33H	£63.60	£53.00
Jaguar	XJ6/XJ12 '74 to '86	F	098.B54H	£63.60	£53.00
Jaguar	XJ6/XJ12 '87 on	F	098.B54AH	£91.20	£76.00
Jaguar	XJS to '89	F	098.B54H	£63.60	£53.00
Jaguar	XJS '90 on	F	098.B54CH	£91.20	£76.00
Jaguar	XJ40	F	098.B54B	£91.20	£76.00
Jensen	Interceptor to 1972	F	098.B7H	£91.20	£76.00
Jensen	Interceptor 1973-1983	F	098.B49JH	£78.00	£65.00
Jensen	Director and FF	F	098.B7H	£91.20	£76.00
Jensen	Jensen Healey	D	098.B35JH	£91.20	£76.00
Land Rover	SWB 1973-1987	Special Order			
Land Rover	Discovery 1987-1995	Special Order			
Land Rover	Defender (36 teeth)	D	098.B34A	£78.00	£65.00
Land Rover	Defender (48 teeth) up to 1996	D	098.B45	£63.60	£53.00
Lotus	7 and Super 7	F	098.B20H	£63.60	£53.00
Lotus	Elan	D	098.B20H	£63.60	£53.00
Lotus	Elite Mk 2	D	098.B20H	£63.60	£53.00
Lotus	Elite Mk 3	D	098.F64H	£78.00	£65.00
Lotus	Elan 2+2 to 1972	D	098.B20H	£63.60	£53.00
Lotus	Elan 2+2 1973 on	D	098.B44	£78.00	£65.00
Lotus	Esprit	D	098.B20B	£78.00	£65.00
Lotus	Eclat	D	098.B20CH	£78.00	£65.00
Lotus	Europa to 1973	D	098.B20H	£63.60	£53.00
Lotus	Elise/Exige	Special Order			
Lotus	Cortina 1965 on	D	098.B18	£78.00	£65.00
Marcos	850GT	F/D	098.B1H	£63.60	£53.00

Continued on next page

- LIGHTING
- SWITCHES
- IGNITION
- WIRING
- HEATERS, ELECTRIC FANS
- FUEL AIR
- GAUGES
- WASHERS WIPERS
- MIRRORS
- SEATS, SEAT BELTS

STEERING WHEELS

- MOTORCYCLE PARTS
- ACCESSORIES
- BODY HARDWARE
- CAR CARE PAINT
- OIL, GREASE
- FITTINGS
- WHEELS, BRAKES
- TOOLS
- COMPETITION
- CLOTHING
- GIFTS
- BOOKS

BOSSES FOR STEERING WHEELS

+44(0) 1885 488 488

LIGHTING
SWITCHES
IGNITION
WIRING
HEATERS,
ELECTRIC
FANS
FUEL AIR
GAUGES
WASHERS
WIPERS
MIRRORS
SEATS, SEAT
BELTS
**STEERING
WHEELS**
MOTORCYCLE
PARTS
ACCESSORIES
BODY
HARDWARE
CAR CARE
PAINT
OIL, GREASE
FITTINGS
WHEELS,
BRAKES
TOOLS
COMPETITION
CLOTHING
GIFTS
BOOKS

Make	Model	Type of Wheel	Boss Part No.	Price each	Ex Vat
Marcos	1600	D	098.B20H	£63.60	£53.00
Marcos	3 litre	D	098.B20H	£63.60	£53.00
Marcos	Mantula	D	098.B20H	£63.60	£53.00
MG	TC	F	098.B7	£91.20	£76.00
MG	TD	F	098.B8	£91.20	£76.00
MG	TF	F	098.B8	£91.20	£76.00
MG	MGA	F	098.B1	£63.60	£53.00
MG	MGB or MGC to 1969	F/D	098.B25H	£63.60	£53.00
MG	MGB 1970	F/D	098.B25BH	£63.60	£53.00
MG	MGB 1971-1976	F/D	098.B25CH	£63.60	£53.00
MG	MGB 1977-1978	F/D	098.B25DH	£63.60	£53.00
MG	MGB 1979-1980	F/D	098.B25D	£63.60	£53.00
MG	MGB and MGC Export Versions	F/D	098.B25A	£63.60	£53.00
MG	MGC U.K.	F/D	098.B25H	£63.60	£53.00
MG	Midget Mk 1	F	098.B4H	£63.60	£53.00
MG	Midget Mk 2/3 and Mk 4 to 1970	F	098.B25H	£63.60	£53.00
MG	Midget Mk 4 1971 on	F	098.B25CH	£63.60	£53.00
MG	Metro	D	098.B45	£63.60	£53.00
MG	Maestro	D	098.B45	£63.60	£53.00
MG	Montego	D	098.B45		£53.00
Mini	850 Mk 1	F/D	098.B1H	£63.60	£53.00
Mini	Mk 1 to take OE Horn Control	F/D	098.B10E	£91.20	£76.00
Mini	850 Mk 2	F/D	098.B1	£63.60	£53.00
Mini	1000	F/D	098.B25	£63.60	£53.00
Mini	Clubman	F/D	098.B25	£63.60	£53.00
Mini	Aug 1977 on	F/D	098.B45	£63.60	£53.00
Mini	City	F/D	098.B45	£63.60	£53.00
Mini	Mayfair	F/D	098.B45	£63.60	£53.00
Mini	Metro all models	F/D	098.B45	£63.60	£53.00
Mini	Moke	F/D	098.B1H	£63.60	£53.00
Mini	Moke to take OE Horn Control	F/D	098.B10E	£91.20	£76.00
Morgan	3 Wheeler		Special Order		
Morgan	Plus 4 to 1965	F	098.B13	£78.00	£65.00
Morgan	Plus 4 1998 on	F	098.B71H	£134.40	£112.00
Morgan	4/4 to 1970	F	098.B13	£78.00	£65.00
Morgan	4/4 1971 on	F	098.B25B	£63.60	£53.00
Morgan	4/4 1998 on	F	098.B71H	£134.40	£112.00
Morgan	Plus 8 to 1970	F	098.B13	£78.00	£65.00
Morgan	Plus 8 1970 on	F	098.B25B	£63.60	£53.00
Morgan	Plus 8 1998 on	F	098.B71H	£134.40	£112.00
Morgan	Roadster	F	098.B71H	£134.40	£112.00
Morgan	Aero 8	F	098.B86	£134.40	£112.00
Morris	Minor Side Valve	F	098.B8	£91.20	£76.00
Morris	Minor 1000	D	098.B1H	£63.60	£53.00
Morris	Cooper Mk 1	F/D	098.B1H	£63.60	£53.00
Morris	Cooper Mk 2	F/D	098.B1	£63.60	£53.00
Morris	Mini Mk 1	F/D	098.B1H	£63.60	£53.00
Morris	Mini Mk 2	F/D	098.B1	£63.60	£53.00
Morris	1100 Mk 1	F/D	098.B25H	£63.60	£53.00
Morris	1100 Mk 2	F/D	098.B25	£63.60	£53.00
Morris	1300	F/D	098.B25	£63.60	£53.00
Morris	GT	F/D	098.B25	£63.60	£53.00

BOSSES FOR STEERING WHEELS

Make	Model	Type of Wheel	Boss Part No.	Price each	Ex Vat
Morris	Clubman	F/D	098.B25	£63.60	£53.00
Morris	Marina	F/D	098.B45	£63.60	£53.00
Panther	Rio	D	098.B23A	£63.60	£53.00
Panther	J72	F	098.B54H	£63.60	£53.00
Panther	De Ville	F	098.B54H	£63.60	£53.00
Panther	Kallista	F	098.B61	£78.00	£65.00
Reliant	Scimitar to 1969	D	098.B20	£63.60	£53.00
Reliant	Scimitar 1970-1976	D	098.B44	£78.00	£65.00
Reliant	Scimitar 1977 on	D	098.B40A	£78.00	£65.00
Rolls-Royce	All models with parallel spline, specify spline diameter	D	098.B70H	£134.40	£112.00
Rolls-Royce	All models with taper spline	Special Order			
Rover	2000 SC & TC,	D	098.B34	£78.00	£65.00
Rover	2200	D	098.B34	£78.00	£65.00
Rover	3500 and 3500S	D	098.B34	£78.00	£65.00
Rover	SD1 3500 to 1981	D	098.B34A	£78.00	£65.00
Rover	SD1 1982 on	D	098.B34B	£78.00	£65.00
Rover	2000, 2300 & 2600 1987 on	D	098.B34B	£78.00	£65.00
Rover	Vitesse	D	098.B34B	£78.00	£65.00
Rover	213 and 216	D	098.F79H	£78.00	£65.00
Range Rover	To 1988	D	098.B51	£78.00	£65.00
Range Rover	1989 on	D	098.B51A	£78.00	£65.00
Sunbeam	Imp Sport	D	098.B27	£78.00	£65.00
Sunbeam	Stillette	D	098.B27	£78.00	£65.00
Sunbeam	Alpine Non Adjustable	F/D	098.B29	£78.00	£65.00
Sunbeam	Alpine Adjustable Column but adjustable function is lost	F/D	098.B30H	£91.20	£76.00
Sunbeam	Tiger Adjustable Column but adjustable function is lost	F/D	098.B30H	£91.20	£76.00
Triumph	TR2/3/3A non adjustable column. Accepts OE horn control	F	098.B220E	£91.20	£76.00
Triumph	TR2/3/3A with adjustable column. Accepts OE horn control	F	098.B77	£91.20	£76.00
Triumph	TR2/TR3/TR3A non adjustable column. With horn control	F	098.B1H	£63.60	£53.00
Triumph	TR4 & A	F/D	098.B20H	£63.60	£53.00
Triumph	TR5	F/D	098.B20AH	£63.60	£53.00
Triumph	TR6	F/D	098.B20H	£63.60	£53.00
Triumph	TR7	F/D	098.B59	£63.60	£53.00
Triumph	Herald	F/D	098.B20H	£63.60	£53.00
Triumph	Vitesse	F/D	098.B20H	£63.60	£53.00
Triumph	2000 to 1969	D	098.B21H	£91.20	£76.00
Triumph	2000 1970 on	D	098.B23	£63.60	£53.00
Triumph	2.5 to 1969	D	098.B21H	£91.20	£76.00
Triumph	2.5 in 1970	D	098.B23	£63.60	£53.00
Triumph	2.5 1971 on	D	098.B23A	£63.60	£53.00
Triumph	1300	F/D	098.B23	£63.60	£53.00
Triumph	Toledo	F/D	098.B23	£63.60	£53.00
Triumph	1500	F/D	098.B23	£63.60	£53.00
Triumph	Dolomite	F/D	098.B23A	£63.60	£53.00
Triumph	Sprint	F/D	098.B23A	£63.60	£53.00
Triumph	Stag	F/D	098.B23A	£63.60	£53.00
Triumph	Spitfire to 1978	F/D	098.B20H	£63.60	£53.00
Triumph	Spitfire 1979 on	F/D	098.B45	£63.60	£53.00
Triumph	GT6 to 1968	F/D	098.B20H	£63.60	£53.00
Triumph	GT6 1969 on	F/D	098.B20AH	£63.60	£53.00
Triumph	Tornado	F/D	098.B23	£63.60	£53.00

Continued on next page

- LIGHTING
- SWITCHES
- IGNITION
- WIRING
- HEATERS, ELECTRIC FANS
- FUEL AIR
- GAUGES
- WASHERS WIPERS
- MIRRORS
- SEATS, SEAT BELTS

STEERING WHEELS

- MOTORCYCLE PARTS
- ACCESSORIES
- BODY HARDWARE
- CAR CARE PAINT
- OIL, GREASE
- FITTINGS
- WHEELS, BRAKES
- TOOLS
- COMPETITION
- CLOTHING
- GIFTS
- BOOKS

BOSSSES FOR STEERING WHEELS

+44(0) 1885 488 488

Make	Model	Type of Wheel	Boss Part No.	Price each	Ex Vat
TVR	All Models to 1969	F/D	098.B20H	£63.60	£53.00
TVR	All Models 1970 to 1987	F/D	098.B45	£63.60	£53.00
TVR	1988 on using Ford Column	D	098.B61	£78.00	£65.00
Vauxhall	Chevette	D	098.B57	£78.00	£65.00
Vauxhall	Viva HC	D	098.B35B	£78.00	£65.00
Vauxhall	Firenza	D	098.B35B	£78.00	£65.00
Vauxhall	Magnum	D	098.B35B	£78.00	£65.00
Vauxhall	Cavalier with tilt adjustable wheel	D	098.F23FH	£134.40	£112.00



Morgan **098.B13**



With Lotus logo **098.B44**



Morgan **098.B71H**

LIGHTING

SWITCHES

IGNITION

WIRING

HEATERS,
ELECTRIC
FANS

FUEL AIR

GAUGES

WASHERS
WIPERS

MIRRORS

SEATS, SEAT
BELTS

STEERING
WHEELS

MOTORCYCLE
PARTS

ACCESSORIES

BODY
HARDWARE

CAR CARE
PAINT

OIL, GREASE

FITTINGS

WHEELS,
BRAKES

TOOLS

COMPETITION

CLOTHING

GIFTS

BOOKS

HORN PUSHES & CAPS

The wrinkle black centre of Moto-Lita bosses can be replaced with a horn push or cap machined from solid aluminium billet and polished. When fitted, the centre of your steering wheel is polished aluminium (no black showing). They are available in two sizes. The smaller one allows the ring of screws securing the steering wheel to the boss to be seen and the larger size covers those screws. If you have a horn push in the centre of your steering wheel order a horn push, and if you don't then order the cap. Both are available with or without an indent for a decal

Moto-Lita



CAP

Without indent for decal
Small size (screws seen)

090.518

£43.20 each | £36.00 ex VAT

Large size (screws hidden)

090.517

£48.00 each | £40.00 ex VAT



HORN PUSH

Without indent for decal
Small size (screws seen)

090.089

£72.00 each | £60.00 ex VAT

Large size (screws hidden)

090.086

£78.00 each | £65.00 ex VAT



JAGUAR E TYPE HORN PUSH

We also offer a special horn push for the Jaguar E Type. Goes with steering wheels Part No.090.061 and Part No. 090.062 (page 198)

090.500

£74.36 each | £61.97 ex VAT



CAP

With indent for decal
Small size (screws seen)

090.520

£43.20 each | £36.00 ex VAT

Large size (screws hidden)

090.519

£48.00 each | £40.00 ex VAT



HORN PUSH

With indent for decal
Small size (screws seen)

090.504

£62.70 each | £52.25 ex VAT

Large size (screws hidden)

090.503

£63.30 each | £52.75 ex VAT



SPACER

Fits between a Moto-Lita boss and their steering wheel to bring the latter closer to you. Black crackle finish. Supplied with 9 longer screws 12.5mm (1/2")

090.858

19mm (3/4")

090.608

25mm (1")

090.859

All one price: £44.40 each | £37.00 ex VAT



STEERING WHEEL RIM & SPOKES

Made in England using the original Bluemel tooling and traditional materials. The spokes are stainless steel with chrome separators. Acetate rim colour black unless stated. For pre-war **J, N, P, TA, L Types** and post-war **TC, TD, TF, MGA**. The black wheel above is shown fitted to a boss. Also for **Morgans** and other cars 356mm (14") diameter

090.607

£241.80 each | £201.50 ex VAT

As above but cream (shown right)

090.614

£259.80 each | £216.50 ex VAT

394mm (15.5") diameter

090.621

£215.12 each | £179.27 ex VAT

432mm (17") diameter

090.620

£215.12 each | £179.27 ex VAT

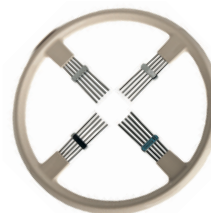

BOSSES FOR MG'S

These enable the above rims to be fitted to:

Pre-war **MGs** including **J, N, P, TA, L Types**, up to about 1938

090.622

£154.64 each | £128.87 ex VAT

MG TC 1946 to 1949

090.623

£148.80 each | £124.00 ex VAT

MG TD & TF from 1949 to 1955. This column has a keyway

090.602

£128.70 each | £107.25 ex VAT

MGA from 1955 to 1962. This column has a spline

090.603

£134.64 each | £112.20 ex VAT

Spare centre brass disc engraved with **MG** logo. Gold colour (shown right)

090.615

£36.00 each | £30.00 ex VAT

BOSS FOR OTHER CARS

This **unbored** boss enables steering wheels Part Nos 090.620 and 090.621 to be fitted to cars of other makes. Supplied with four bolts/nuts/washers which clamp parts together

090.624

£135.24 each | £112.70 ex VAT

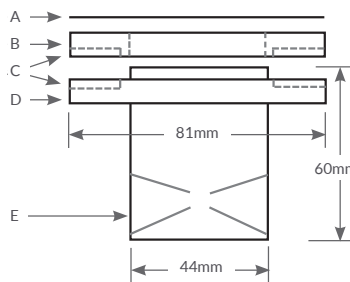

- A - Brass disc suitable for engraving/etching or replacing with logo etc relating to your car
- B - Top plate
- C - Bluemels steering wheel fits here into slots provided
- D - Cast aluminium boss. You will need to machine it to suit the column of your car. This could involve machining a taper, a spline or keyway, and slitting and cross drilling it to make it clamp your column. Surfaces are polished
- E - Bosses for cross drilling



BOSSES FOR MORGANS

These enable the above rims to be fitted to:

Morgans up to 1971 with non-collapsible splined column, shown left

090.617

£152.52 each | £127.10 ex VAT

Morgans with collapsible column - later cars (no horn push), shown right

090.618

£148.80 each | £124.00 ex VAT



SPARE BLOCKS FOR SEPARATING SPOKES:

Chrome (left)

090.616

£9.60 each | £8.00 ex VAT

Enamelled (right)

090.619

£24.00 each | £20.00 ex VAT

LIGHTING

SWITCHES

IGNITION

WIRING

HEATERS,
ELECTRIC
FANS

FUEL AIR

GAUGES

WASHERS
WIPERS

MIRRORS

SEATS, SEAT
BELTS

**STEERING
WHEELS**

MOTORCYCLE
PARTS

ACCESSORIES

BODY
HARDWARE

CAR CARE
PAINT

OIL, GREASE

FITTINGS

WHEELS,
BRAKES

TOOLS

COMPETITION

CLOTHING

GIFTS

BOOKS

GEAR KNOBS

+44(0) 1885 488 488

GTO Gear Lever Knobs are machined from billet aluminium



ALUMINIUM GEAR KNOB

With no provision for a decal

091.227

£27.55 each | £22.96 ex VAT



ALUMINIUM GEAR KNOB

For standard gearboxes. With provision for decal

091.229

£29.95 each | £24.96 ex VAT



ALUMINIUM GEAR KNOB

For gearboxes where the knob is lifted to obtain reverse. With provision for decal

091.228

£29.95 each | £24.96 ex VAT

The Monte range of Gear Knobs is still being manufactured by the original 1960s factory in genuine wood or leather, with a choice of decals as shown below and right. They are especially suitable for cars of the 50s and 60s. They are easy to fit



STANDARD WOOD

091.972

£9.60 each | £8.00 ex VAT



STANDARD LEATHER

091.973

£9.60 each | £8.00 ex VAT



4-SPEED DECAL

091.730

£3.84 each | £3.20 ex VAT



4-SPEED DECAL

091.735

£3.84 each | £3.20 ex VAT



5-SPEED DECAL

091.731

£3.84 each | £3.20 ex VAT



5-SPEED DECAL

091.732

£3.84 each | £3.20 ex VAT

SEE ALSO 'GEAR LEVER AND STEERING WHEEL DECALS' ON THE FOLLOWING PAGE



MGB TYPE

(Left) Plastic with a brass insert tapped $\frac{5}{16}$ " UNF. MGB gear lever knob up to 1967

091.226

£11.94 each | £9.95 ex VAT

These Decals are for Gear Knobs & Steering Wheel Bosses



ALVIS
091.420
£3.84 each | £3.20 ex VAT



ASTON MARTIN
091.426
£3.84 each | £3.20 ex VAT



AUDI
091.231
£3.84 each | £3.20 ex VAT



AUSTIN HEALEY SPRITE
091.233
£3.84 each | £3.20 ex VAT



BMC
091.421
£3.84 each | £3.20 ex VAT



CHEQUERED FLAGS
091.777
£3.84 each | £3.20 ex VAT



COBRA
091.422
£3.84 each | £3.20 ex VAT



COOPER
091.235
£3.84 each | £3.20 ex VAT



FORD
091.423
£3.84 each | £3.20 ex VAT



FORD RS
091.238
£3.84 each | £3.20 ex VAT



JAGUAR
091.240
£3.84 each | £3.20 ex VAT



JAGUAR CAT
091.775
£3.84 each | £3.20 ex VAT



LOTUS
091.244
£3.84 each | £3.20 ex VAT



MINI
091.242
£3.84 each | £3.20 ex VAT



MG
091.427
£3.84 each | £3.20 ex VAT



MORGAN
091.733
£3.84 each | £3.20 ex VAT



MORGAN
091.186
£3.84 each | £3.20 ex VAT



RILEY
091.424
£3.84 each | £3.20 ex VAT



ROVER
091.776
£3.84 each | £3.20 ex VAT



GT
091.247
£3.84 each | £3.20 ex VAT



STARS & STRIPES
091.248
£3.84 each | £3.20 ex VAT



TRIUMPH
091.425
£3.84 each | £3.20 ex VAT



TVR
091.245
£3.84 each | £3.20 ex VAT



UNION JACK
091.249
£3.84 each | £3.20 ex VAT

- LIGHTING
- SWITCHES
- IGNITION
- WIRING
- HEATERS, ELECTRIC FANS
- FUEL AIR
- GAUGES
- WASHERS WIPERS
- MIRRORS
- SEATS, SEAT BELTS
- STEERING WHEELS**
- MOTORCYCLE PARTS
- ACCESSORIES
- BODY HARDWARE
- CAR CARE PAINT
- OIL, GREASE
- FITTINGS
- WHEELS, BRAKES
- TOOLS
- COMPETITION
- CLOTHING
- GIFTS
- BOOKS

ENGINE DECALS

+44(0) 1885 488 488

Sets of reproduction decals for the underbonnet of a particular car. The decals are either adhesive or metal like the originals

LIGHTING

SWITCHES

IGNITION

WIRING

HEATERS,
ELECTRIC
FANS

FUEL AIR

GAUGES

WASHERS
WIPERS

MIRRORS

SEATS, SEAT
BELTS

**STEERING
WHEELS**

MOTORCYCLE
PARTS

ACCESSORIES

BODY
HARDWARE

CAR CARE
PAINT

OIL, GREASE

FITTINGS

WHEELS,
BRAKES

TOOLS

COMPETITION

CLOTHING

GIFTS

BOOKS



AUSTIN HEALEY SPRITE MK I

As shown
091.157
£21.00 each | £17.50 ex VAT



AUSTIN HEALEY BN4-BT8

BN4-BT7
091.158
£21.00 each | £17.50 ex VAT
BN7-BJ8 (shown)
091.159
£21.00 each | £17.50 ex VAT



MG MIDGET

1961-66
091.178
£15.00 each | £12.50 ex VAT
1967-69
091.179
£15.00 each | £12.50 ex VAT
1970-72
091.180
£15.00 each | £12.50 ex VAT
1972-74
091.181
£15.00 each | £12.50 ex VAT
1975-80 (shown)
091.182
£15.00 each | £12.50 ex VAT



MGA 1955-62

Roadster (shown)
091.160
£21.06 each | £17.55 ex VAT
Coupe
091.161
£21.06 each | £17.55 ex VAT



MGB ROADSTER

1961-65
091.162
£21.06 each | £17.55 ex VAT
1965-67
091.163
£20.82 each | £17.35 ex VAT
1968-69
091.164
£13.08 each | £10.90 ex VAT
1970-71 (shown)
091.165
£15.00 each | £12.50 ex VAT
1972-75
091.166
£15.00 each | £12.50 ex VAT
1975-80
091.167
£15.00 each | £12.50 ex VAT



MGBGT

1965-67
091.168
£15.00 each | £12.50 ex VAT
1968-69 (shown)
091.169
£15.00 each | £12.50 ex VAT
1970-71
091.170
£15.00 each | £12.50 ex VAT
1972-75
091.171
£15.00 each | £12.50 ex VAT
1975-80
091.172
£15.00 each | £12.50 ex VAT



MGBGT V8

As shown
091.173
£15.00 each | £12.50 ex VAT



MGC ROADSTER 1967-69

UK
091.174
£15.00 each | £12.50 ex VAT
USA (shown)
091.176
£21.00 each | £17.50 ex VAT



MCGT 1967-69

UK
091.175
£15.00 each | £12.50 ex VAT
USA (shown)
091.177
£21.00 each | £17.50 ex VAT

Andre Hartford Shock Absorbers are suitable for use on all makes of vintage car, and for all types of road and track events. This is the latest high efficiency model



New improved friction discs, specially treated and impregnated, to resist the weather and give a smooth damping action under the most extreme working conditions

A self locking indicator clearly registering the degree of adjustment which cannot work loose

Dual control springs on either side of the shock absorber giving an accurate pressure adjustment

New type non-corrosive friction plates unaffected by weather conditions



Sizes	Suitable for use on cars up to:
3½" single disc	1 tonne
3½" multiple disc	2 tonne
4½" single disc	1½ tonne
4½" multiple disc	2 tonne

(1 tonne = 20 cwt)

All arms are fitted with rubber bushes. These require no lubrication or attention, always remain silent in action, and have a long life

Arms length	3½" Diameter Single Disc 1 blade into 2	3½" Diameter Multiple Disc 2 blades into 3	4½" Diameter Single Disc 1 blade into 2	4½" Diameter Multiple Disc 2 blades into 3
4½"	065.001	065.012	065.023	065.036
5"	065.002	065.013	065.024	065.037
5½"	065.003	065.014	065.025	065.038
6"	065.004	065.015	065.026	065.039
6½"	065.005	065.016	065.027	065.040
7"	065.006	065.017	065.028	065.041
7½"	065.007	065.018	065.029	065.042
8"	065.008	065.019	065.030	065.043
8½"	065.009	065.020	065.031	065.044
9"	065.010	065.021	065.032	065.045
9½"			065.033	065.046
10"			065.034	065.047
Price each	£150.00 £125.00 ex VAT	£178.80 £149.00 ex VAT	£156.00 £130.00 ex VAT	£198.00 £165.00 ex VAT

All shock absorber arms are finished in black enamel, with 3 colour indicator dial. Bolt, stars and locking rings are bright cadmium finish. Brass interleaving rings and wood friction discs in natural finish. Length of arms is measured from the centre of the indicator disc to the centre of each mounting bush. If you require shock absorbers with unequal length arms, please ask our Help Line for a quotation, prices are higher than with equal length arms

- LIGHTING
- SWITCHES
- IGNITION
- WIRING
- HEATERS, ELECTRIC FANS
- FUEL AIR
- GAUGES
- WASHERS WIPERS
- MIRRORS
- SEATS, SEAT BELTS

STEERING WHEELS

- MOTORCYCLE PARTS
- ACCESSORIES
- BODY HARDWARE
- CAR CARE PAINT
- OIL, GREASE
- FITTINGS
- WHEELS, BRAKES
- TOOLS
- COMPETITION
- CLOTHING
- GIFTS
- BOOKS



FRICITION DISC
2.5mm thick for 3½"
065.054
£5.89 each | £4.91 ex VAT
4.5mm thick for 3½"
065.055
£6.83 each | £5.69 ex VAT
2.5mm thick for 4½"
065.065
£7.39 each | £6.16 ex VAT
4.5mm thick for 4½"
065.066
£7.02 each | £5.85 ex VAT



BRASS DISC
For 3½"
065.061
£8.42 each | £7.02 ex VAT
For 4½"
065.069
£10.76 each | £8.97 ex VAT



STAR SPRING
For 3½"
065.059
£15.82 each | £13.18 ex VAT
For 4½"
065.067
£16.75 each | £13.96 ex VAT



INDICATOR DIAL
With backplate
For 3½"
065.060
£13.57 each | £11.31 ex VAT
For 4½"
065.068
£12.64 each | £10.53 ex VAT



POINTER & LOCKING TAG
For 3½" and 4½"
065.062
£10.67 each | £8.89 ex VAT



LOCATING RING
For 3½" and 4½"
065.063
£3.47 each | £2.89 ex VAT



CENTRE BOLT & NUT
Single disc for 3½" and 4½"
065.057
£9.26 each | £7.72 ex VAT
Multiple disc 3½" and 4½"
065.058
£10.39 each | £8.66 ex VAT



BUSHES
Rubber Bush for 3½" and 4½"
(shown left)
065.064
£17.22 each | £14.35 ex VAT
Centre Bush for 3½" and 4½"
(shown right)
065.056
£7.96 each | £6.63 ex VAT



NUTS
Special Castle Nut ½" BSF, deep slotted, countersunk, (shown left)
065.052
£5.94 each | £4.95 ex VAT
Standard ½" BSF Full Nuts (shown right)
065.053
£1.55 each | £1.29 ex VAT



CHASSIS MOUNTING BOLT
Overall length 82.5mm, length of hexagonal portion 4.75mm
065.049
£18.13 each | £15.11 ex VAT
Overall length 97mm, length of hexagonal portion 27mm
065.051
£18.13 each | £15.11 ex VAT
Overall length 111mm, length of hexagonal portion 17.5mm
065.050
£18.13 each | £15.11 ex VAT